

REV.	DESCRIPTION	DATE	STATUS	APPROVED BY
A	NEW ISSUE	02/06/2017	ISSUED	TP

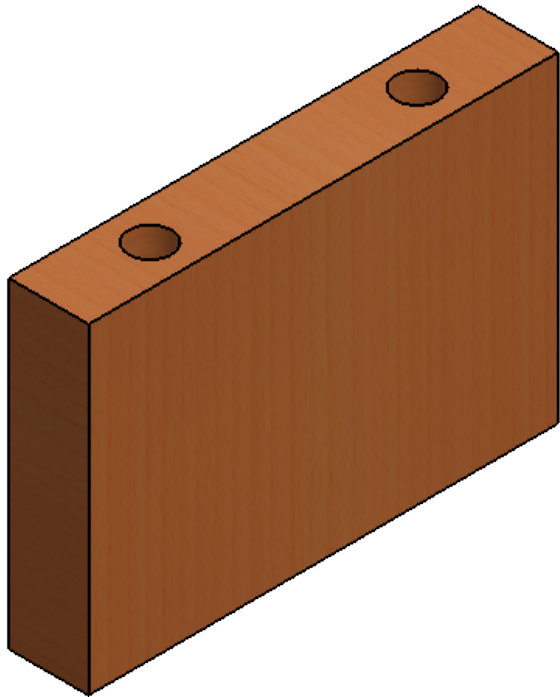

DO NOT SCALE DRAWING - DRAWN ON SOLIDWORKS
IF IN DOUBT ASK

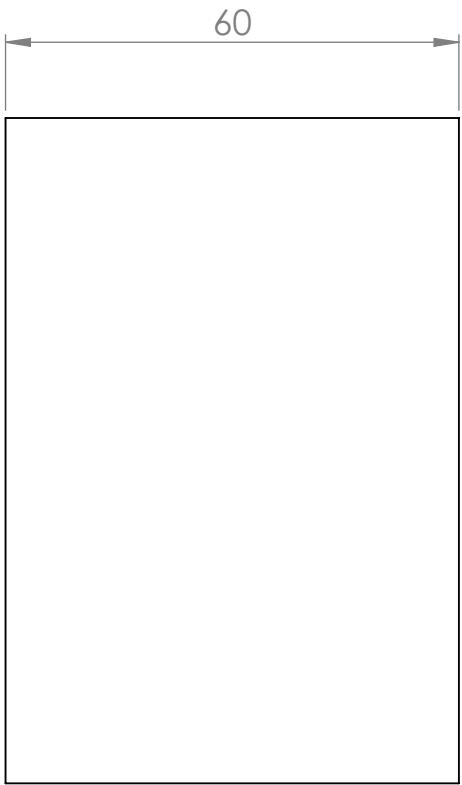
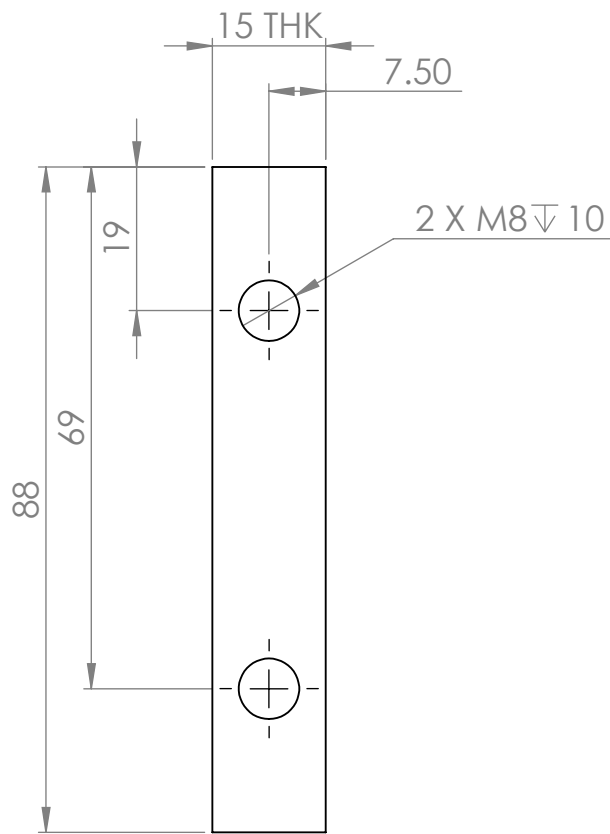
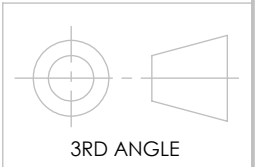

 Home Office Centre for Applied Science and Technology Woodcock Hill Sandridge St Albans AL4 9HQ Tel: 01727-815051 Email: cast@homeoffice.gsi.gov.uk	UNLESS OTHERWISE SPECIFIED: 1. DIMENSIONS ARE IN MILLIMETRES 2. SURFACE FINISH: 1.6µm 3. GENERAL TOLERANCES: ±0.10 4. HOLES: ±0.10 5. ANGLES: ±0.25° 6: DE-BURR ALL HOLES & SHARP EDGES		MATERIAL: PLYWOOD	FINISH: NATURAL
			SECURITY: OFFICIAL	WEIGHT: 12.51 g
				VOLUME: 78194.69 mm³
			TITLE: BALLISTIC TRAY SUPPORT EXTENSIONS - EDGE RESTRAINTS	
			DWG NO: M101277	JOB NUMBER : D04/17
HOME OFFICE CENTRE FOR APPLIED SCIENCE AND TECHNOLOGY (HOME OFFICE CAST) ©2017. THIS DOCUMENT CONTAINS COMMERCIAL SENSITIVE INFORMATION, ITS CONTENTS ARE THE PROPERTY OF HOME OFFICE CAST. IT MAY NOT BE USED, COPIED OR DISCLOSED WITHOUT THE PRIOR AUTHORIZATION OF HOME OFFICE CAST. PRINTED COPIES MUST BE KEPT SECURE AND NOT READ IN AN UNSECURE ENVIRONMENT. THIS DOCUMENT IS RETURNABLE ON DEMAND.		PROJECT NAME : REV BDY ARM STD PROJECT CODE : 183 ADELPHI CODE : 9564130	USED ON: M101273 STEP FILE NAME : STEP-M101277-A FILENAME: M101277 STL FILE NAME : STL-M101277-A DXF FILE NAME : DXF-M101277-A	
			SCALE: 1:1	SHEET 1 OF 1 A3